

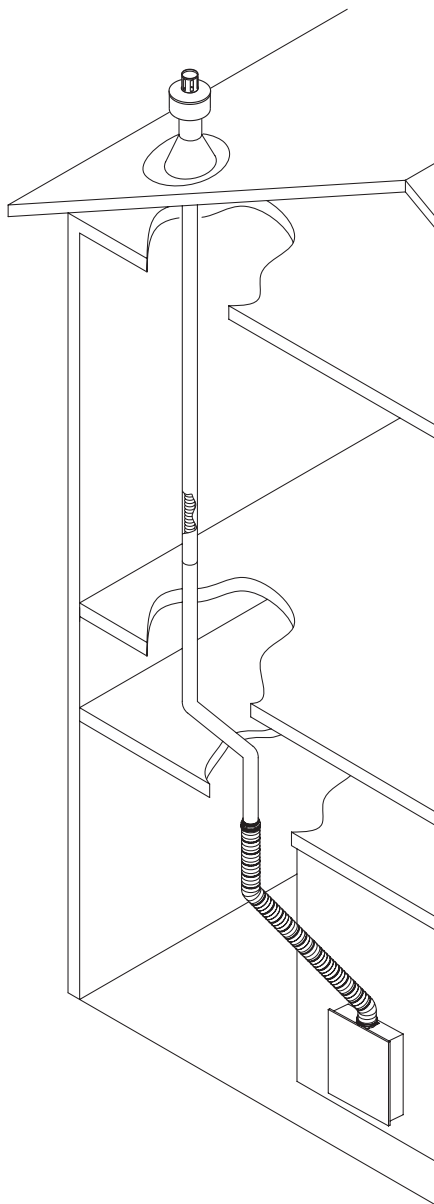

# EZTR40 START-UP GUIDE

## VENT KIT FOR TANKLESS WATER HEATER



EZ2FV35SUG-2  
Rev. 12/ 15

1-866-766-7489  
[WWW.NORITZ.COM](http://WWW.NORITZ.COM)

SCAN FOR  
INSTALLATION VIDEO

# PRE-INSTALLATION

## PLANNING INSTALLATION

Compare all parts with the Package Contents list. If any part appears missing or damaged, do not install this kit. Contact Customer Service immediately at 1-866-766-7489.

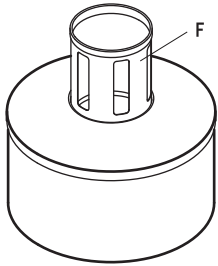

### Universal Rain Cap

This is the default, universal rain cap that can be used to replace the former rain cap at the installation site. It enables you to easily cut the flex pipe and install without having to take into consideration the varying rain caps and their different fittings and sizes.

#### PLEASE PAUSE FOR A MOMENT

Please verify if the installation of a rain cap of different appearance will conflict with Home Owners Associations rules to prevent future issues.

If OK, please proceed with installation.

If NOT, please contact customer service at 1-866-766-7489 to purchase optional installation kit for the existing Rain Cap.

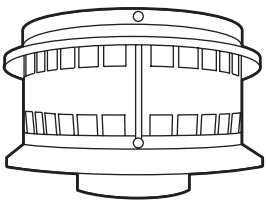

### Brand Name Rain Cap

Sometimes you may run into scenarios when Home Owners Associations have rules preventing rain caps that vary in appearance. If this is the case, please contact customer service at 1-866-766-7489 to purchase optional installation kit for the existing Rain Cap.

## TOOLS REQUIRED



Marker

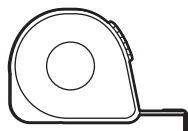

Tape  
Measure



Flathead  
Screwdriver



2 Inch PVC Cutter  
Box Cutter

# PRE-INSTALLATION

## PACKAGE CONTENTS

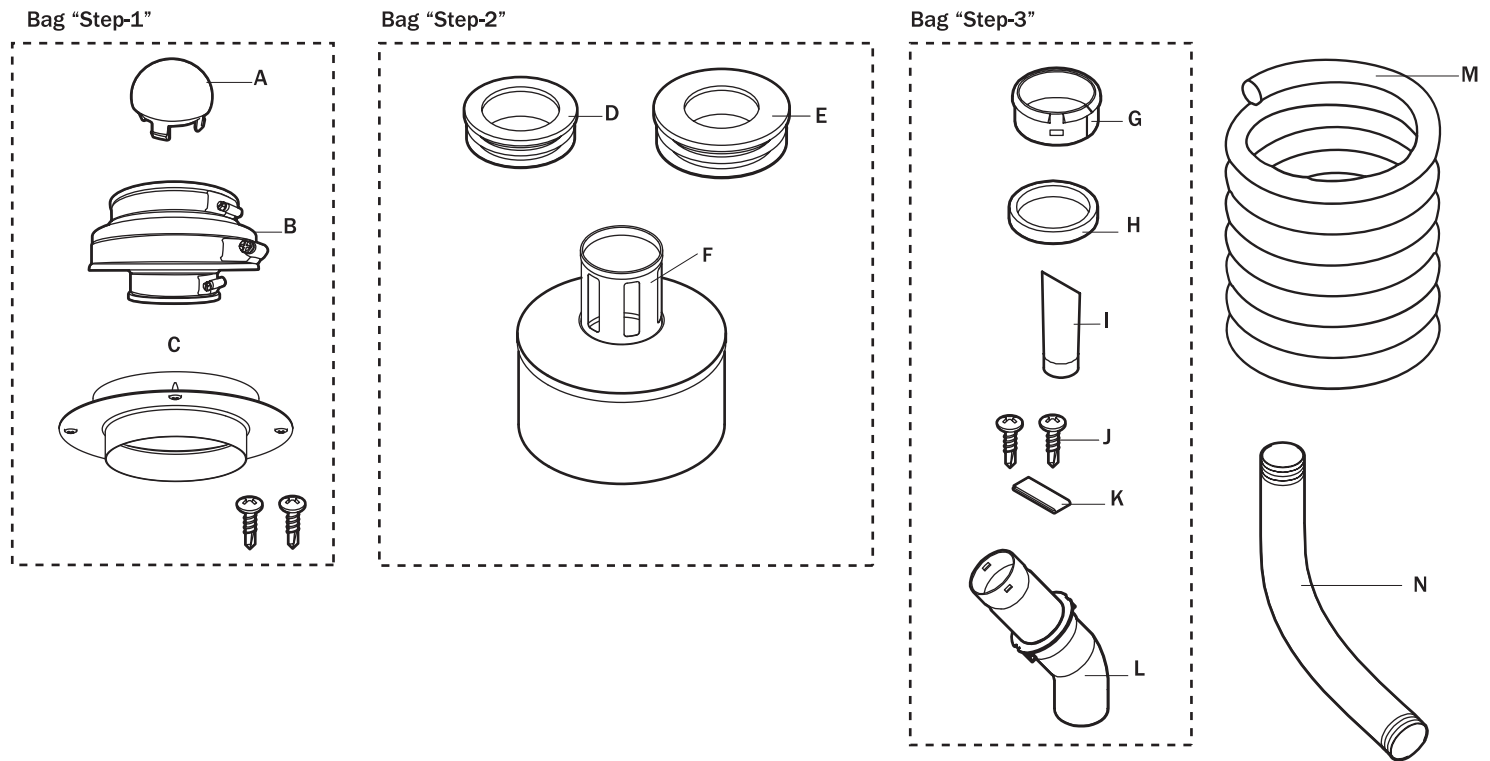

Part	Description	Quantity
A	Flex feeder	1
B	Base junction support	1
C	Base junction adapter set	1
D	Top flex support for 3"	1
E	Top flex support for 4"	1
F	Universal rain cap	1
G	Coupler retainer	1

Part	Description	Quantity
H	Coupler O-ring	1
I	O-ring lubricant	1
J	Screws	2
K	Aluminum tape	1
L	Coupler Set	1
M	Flex pipe	1
N	Flex sleeve	1

## INSTALLATION

- 1** Remove the B-vent from the ceiling down and the tank.

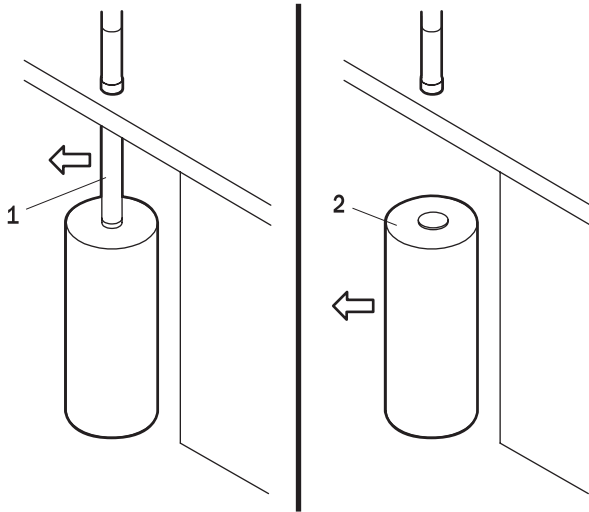

- 2** Measure the vent length from the bottom of the B-Vent to the roof termination.

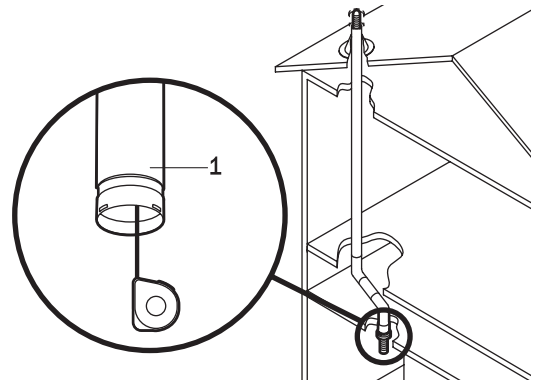

- 3** Determine the size of your venting.  
Is it 3" or 4"?

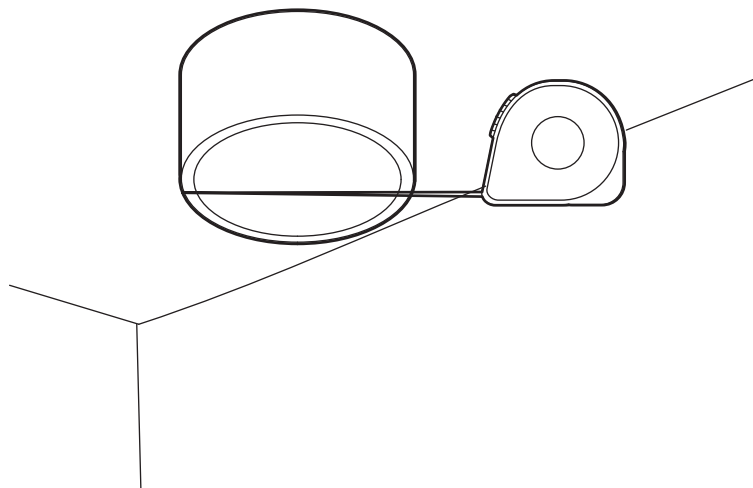

# INSTALLATION (CONTINUED)

## 4 Install the base junction support based on the 3" or 4" venting structure.



Be sure to do

If the strength of the ceiling is not sufficient (i.e. plasterboard), take appropriate measures to ensure safe installation.

### 3" B-vent Termination

OR

### 4" B-vent Termination

4A

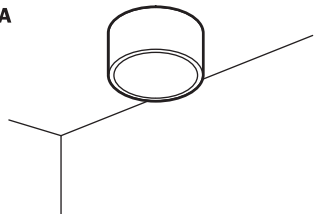

- 1 Install the base junction support onto the B-vent.

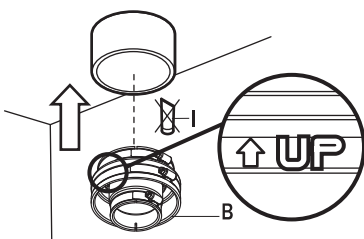

4B

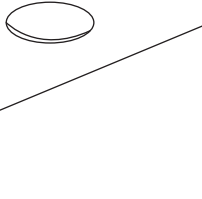

If no B-vent is protruding, install the base junction adapter.

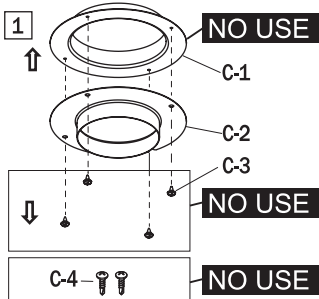

- 2 Screw the base junction adapter into place.

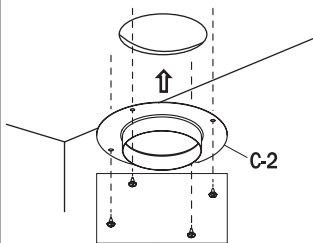

Use appropriate screws for the ceiling.  
(must be field supplied.)

- 3 Install the base junction support onto the base junction adapter.

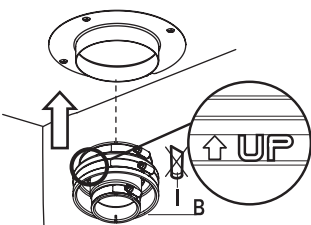

4C

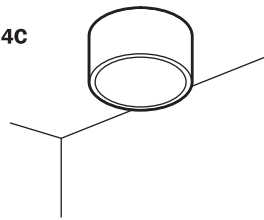

If B-vent is protruding, install the base junction adapter.

- 1 Insert base junction adapter into B-vent

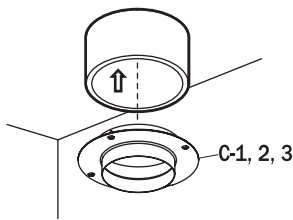

- 2 Screw the base junction adapter into place.

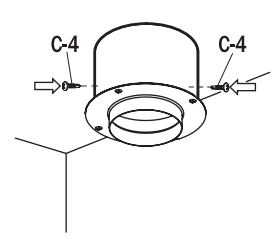

- 3 Install the base junction support onto the base junction adapter.

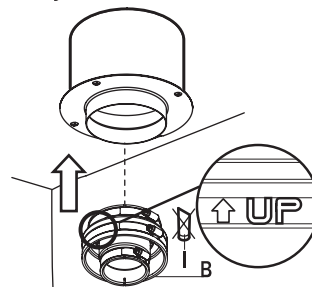

4D

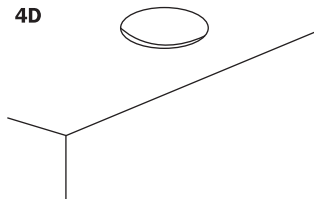

If no B-vent is protruding, install the base junction adapter.

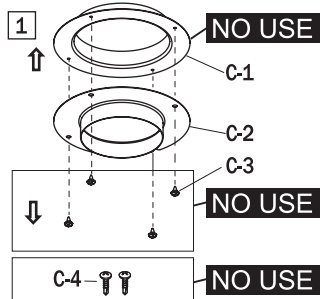

- 2 Screw the base junction adapter into place.

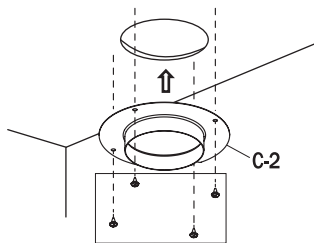

Use appropriate screws for the ceiling.  
(must be field supplied.)

- 3 Install the base junction support onto the base junction adapter.

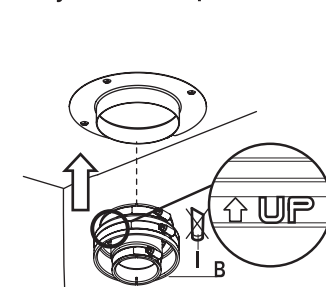

## INSTALLATION (CONTINUED)

### 5 Install the flex pipe into the B-vent.

- Attach the flex feeder **1** and feed flex pipe through the B-vent to the rain cap **2**. Mark and tighten **3**.

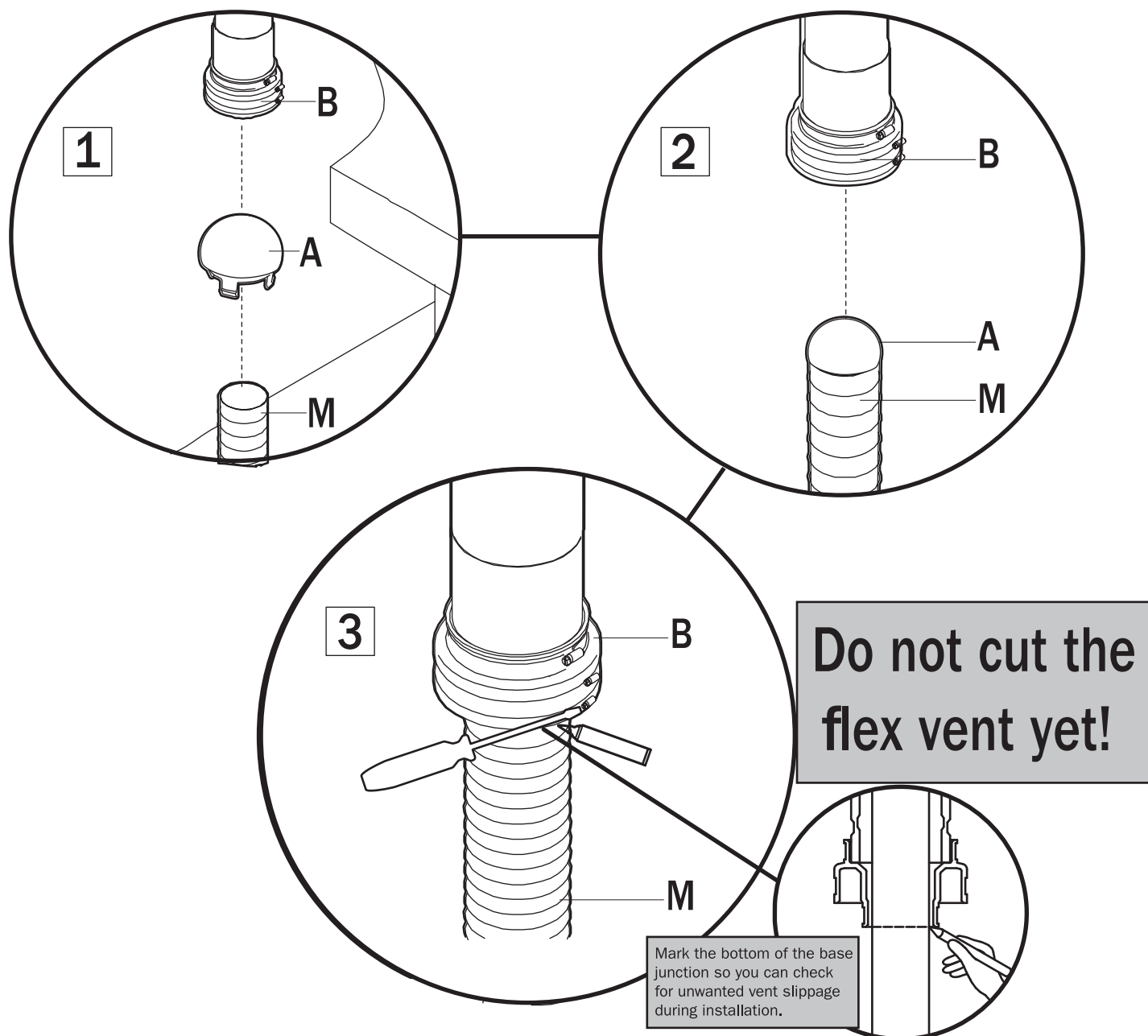

## INSTALLATION (CONTINUED)

### 6 Remove the rain cap.

#### WARNING

Use extreme caution when working on rooftops.

- Climb up to the roof, remove the rain cap and place it in parts bag Step-2, ensuring it will not fall off. Clean any debris from the inside of the B-vent.

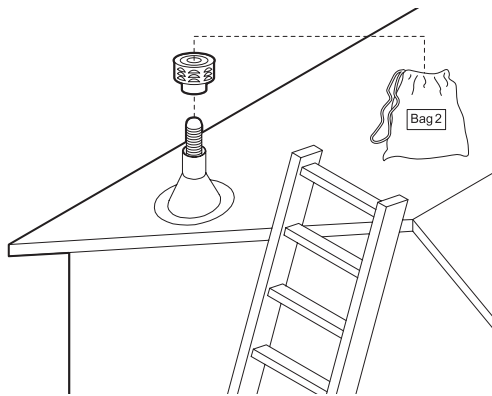

### 7 Mark the position of the flex pipe.

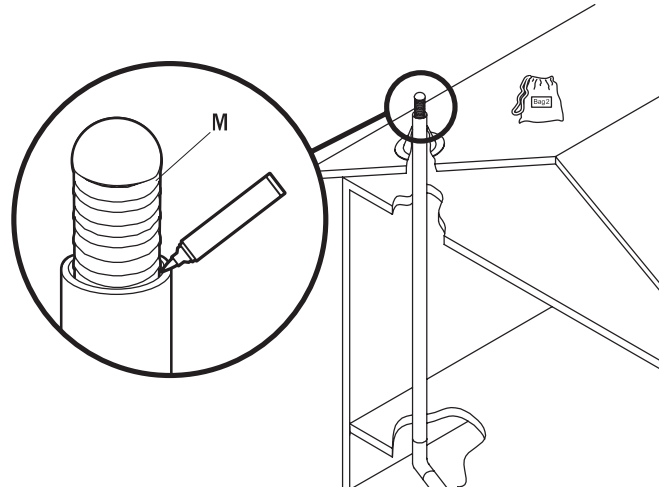

### 8 Slide flex support over flex pipe and press into B-vent.

For **3"** B-vent termination

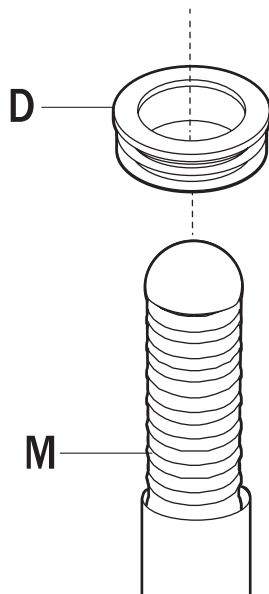

OR

For **4"** B-vent termination

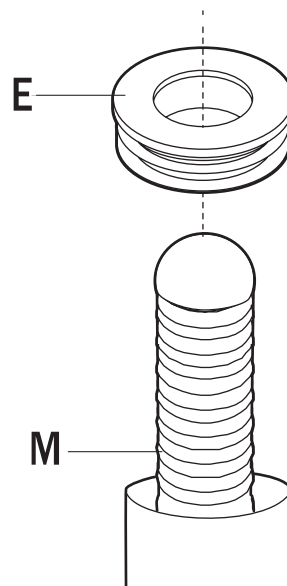

## INSTALLATION (CONTINUED)

- 9** Check and make sure the mark is still visible after sliding the flex support over the flex pipe.

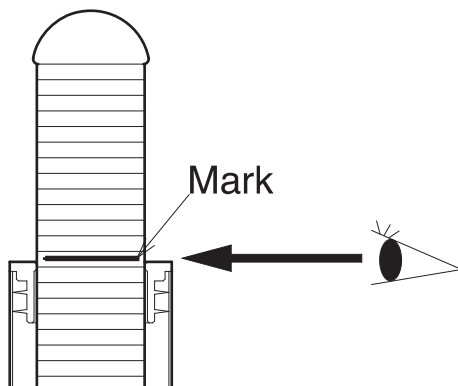

### PLEASE PAUSE FOR A MOMENT

Please verify if the installation of a rain cap of different appearance will conflict with Home Owners Association rules to prevent future issues.

If OK, please proceed with step 10.

If NOT, please contact customer service at 1-866-766-7489 to purchase the optional installation kit for the existing Rain Cap.

- 10** Cut the flexpipe according to the mark. Insert rain cap adapter until flex support is covered.

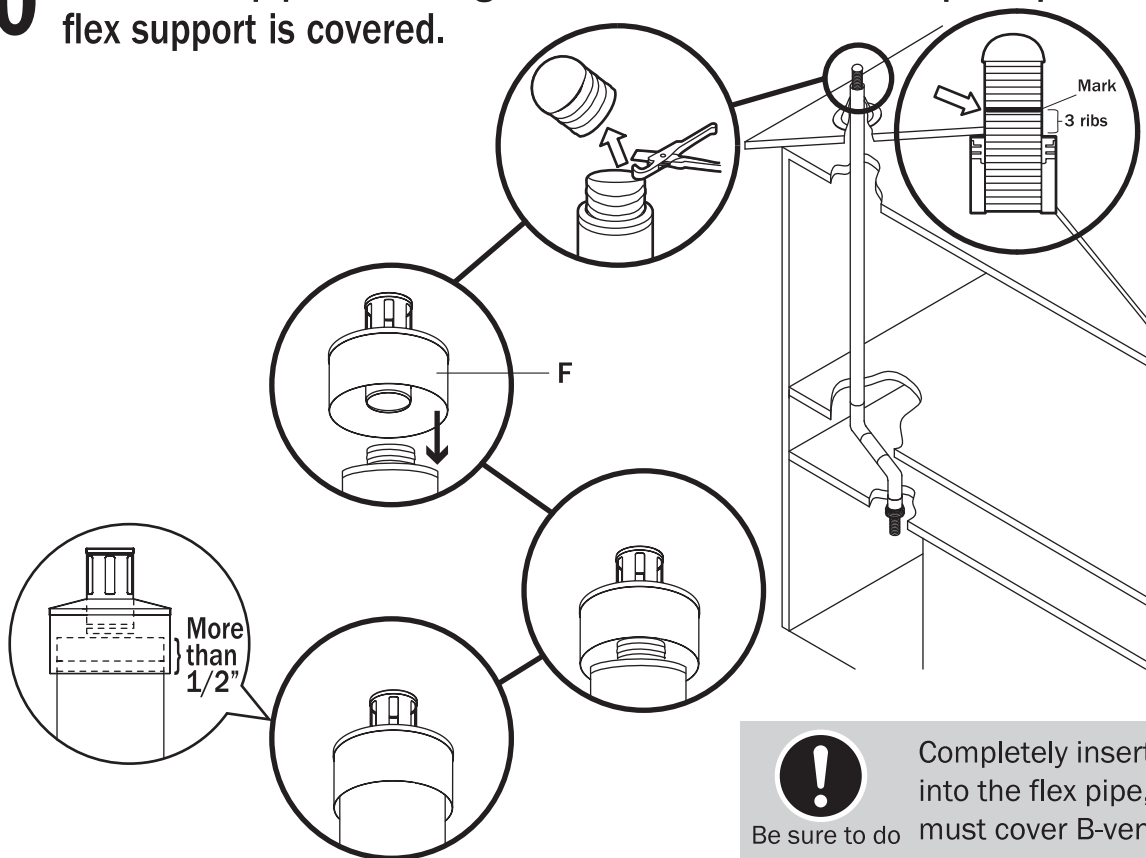

Be sure to do Completely insert Universal Rain Cap into the flex pipe, Universal Rain Cap must cover B-vent by 1/2".



## INSTALLATION (CONTINUED)

- 11** Install the water heater according to the EZTR40 Installation Manual.

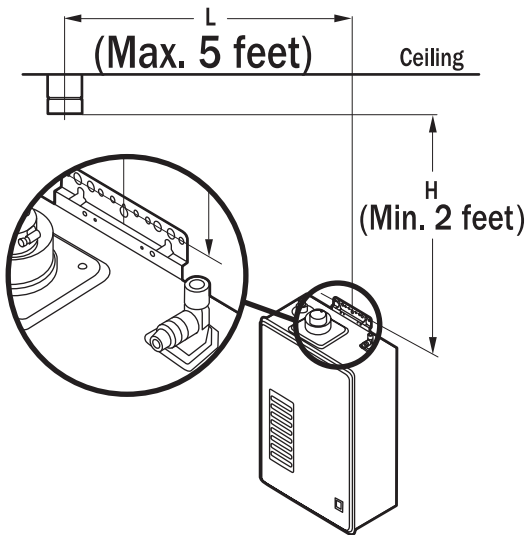

- 12** Attach the Coupler Set to the connector pipe until fully seated.

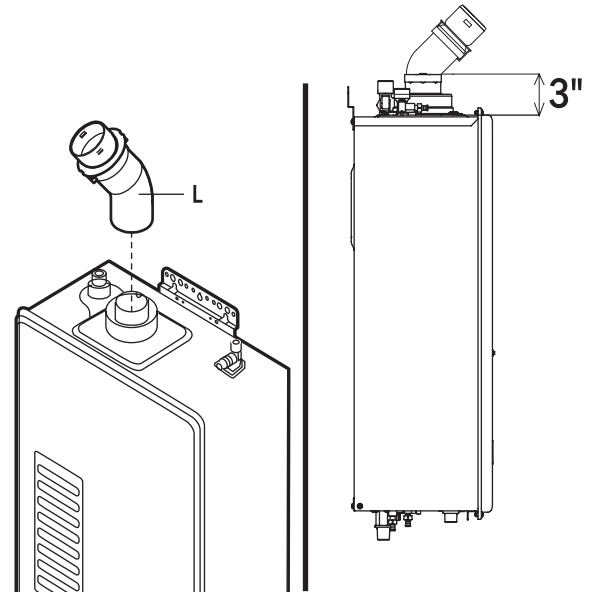

- 13** Cut the flex pipe to the appropriate length (longer length better than shorter). **Flex vent cannot be lengthened after this point!**

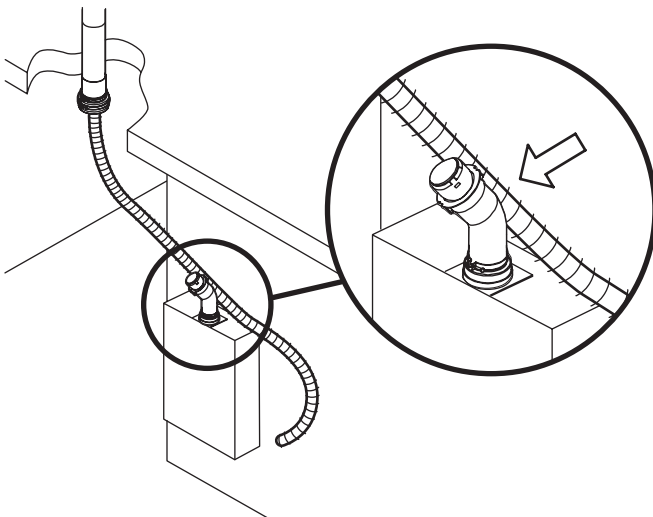

- 14** Install flex sleeve, cut if necessary. Remove flex sleeve if cutting is required.

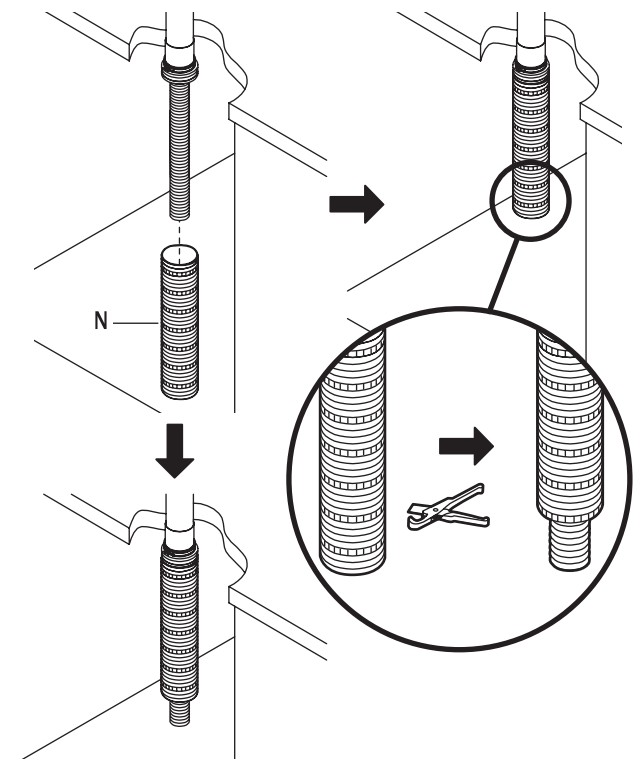

## INSTALLATION (CONTINUED)

- 15** Tighten base junction support to secure the flex sleeve.

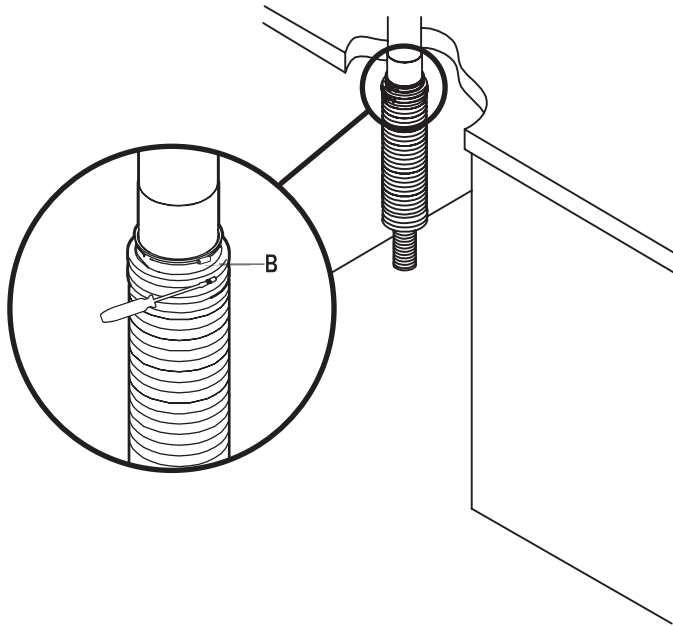

- 16** Attach O-ring and coupler retainer. Ensure there is no space between the O-ring and coupler.

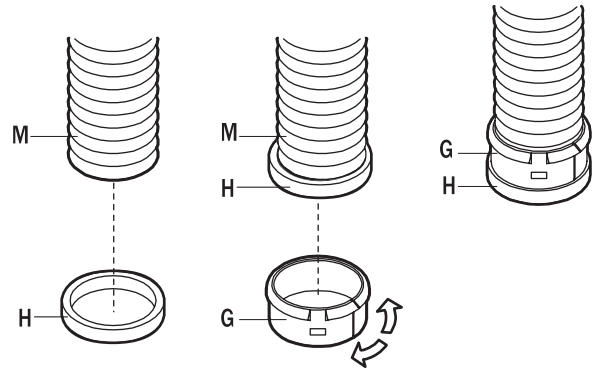

- 17** Remove Coupler Set from the top of the heater and attach to the coupler fitting with lubricant.

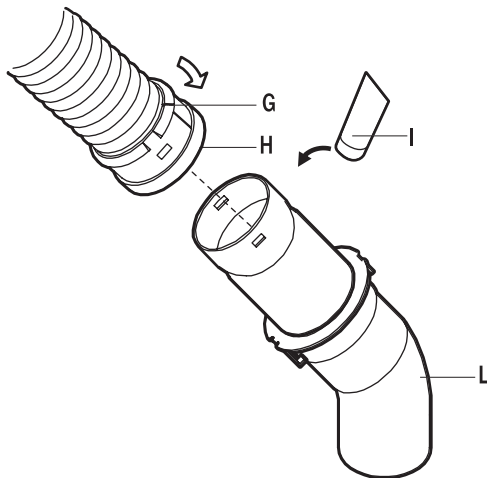

- 18** Re-connect the Coupler Set to the heater.

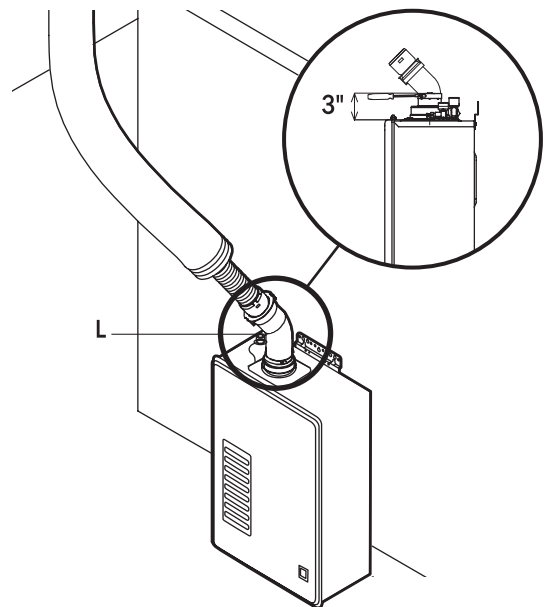

Be sure to do

Do not disassemble  
"Coupler Set" to use.

## INSTALLATION (CONTINUED)

- 19** Test the system for carbon monoxide leaks.

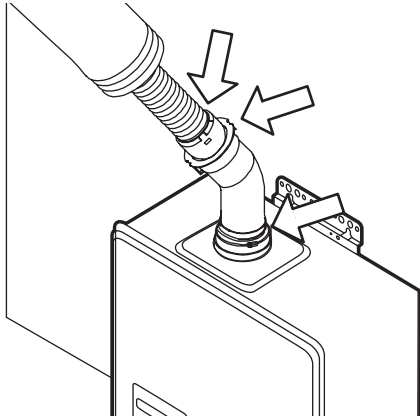

- 20** Extend the flex sleeve to the top of the heater. Secure with screws and aluminum tape.

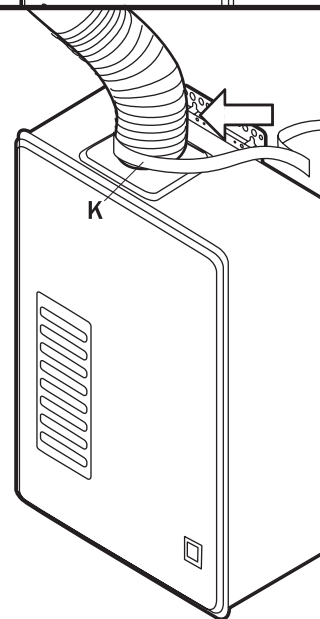
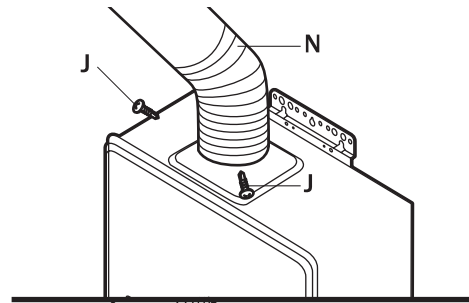
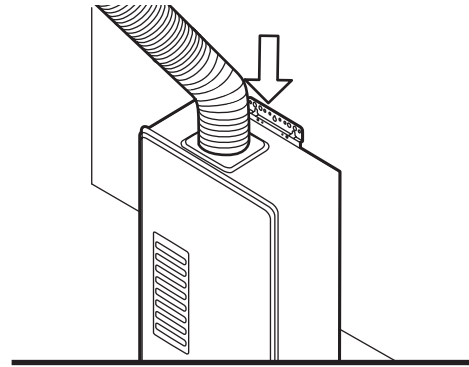

- 21** Calculate total vent length and adjust dip switch on the heater if required. Refer to EZTR40 Installation Manual.

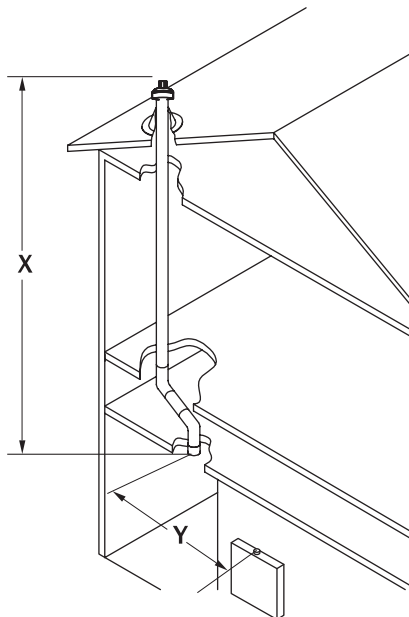

Adjust dip switch on the heater appropriately, for proper heater operation  
Be sure to do



**1-866-766-7489**

**[WWW.NORITZ.COM](http://WWW.NORITZ.COM)**